

# PRINTABLE INFO SHEET

**Series: Blue Ridge MAX**  
**Model: B4252445 Grandview Max**



## About This Model

**Style: Ranch / Bedrooms: 3 / Bathrooms: 2 / Square Feet: 1638**

## CUSTOMER CONTACT

Notes: \_\_\_\_\_  
\_\_\_\_\_  
\_\_\_\_\_  
\_\_\_\_\_

# PRINTABLE INFO SHEET



Series: Blue Ridge MAX

Model: B4252445 Grandview Max

## Floorplan

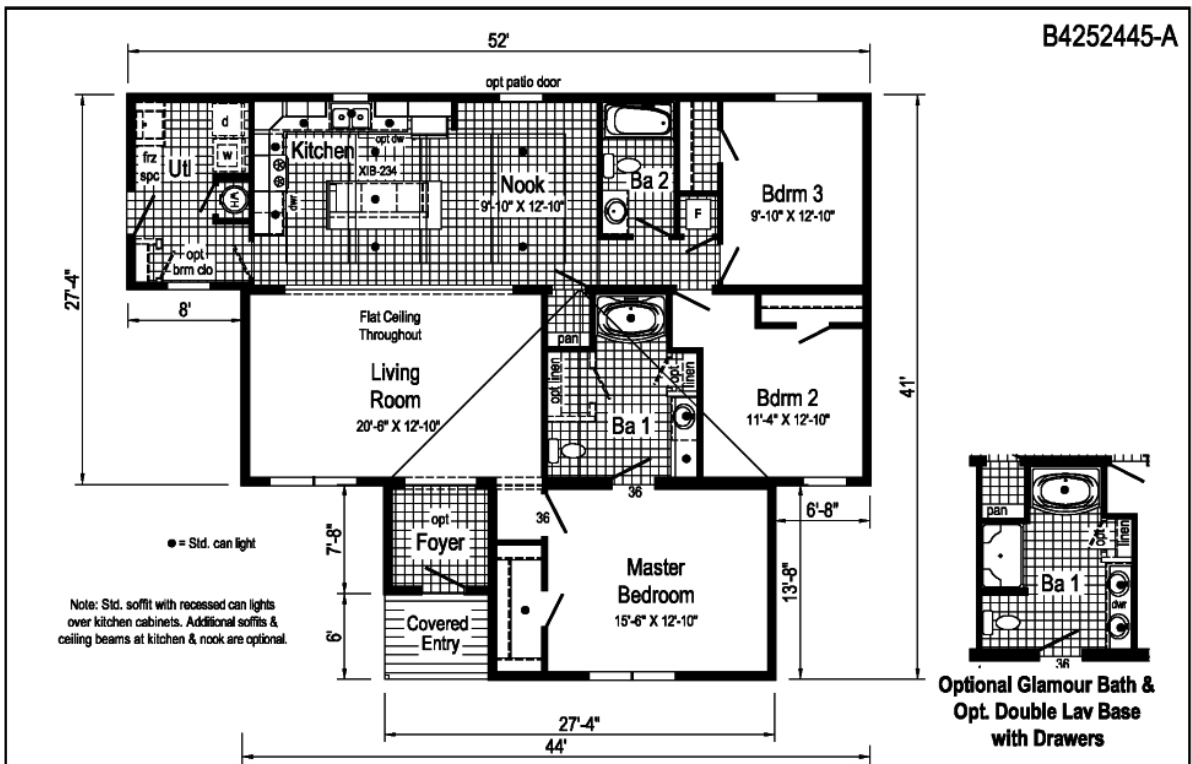

B4252445-A 4252/44 Approx. 1638 Sq. Ft.

Grandview Max 42

Builder: R-Anell Housing Group, LLC - Subsidiary of The Commodore Corp.	Callout: 4252444	Revisions: 1-10-17	Scale: 1/8" = 1'-0"	Date: 5-4-2015	Cost: -	Model/Equip. No.: B4252445-A
Title: Literature	Date: 10-12-15	Number: 10-18-15	Drawn By: BF	Reference: B4252441-A	Dir: -	Pg: LIT

## CUSTOMER CONTACT

Notes: \_\_\_\_\_

\_\_\_\_\_

\_\_\_\_\_

\_\_\_\_\_

# PRINTABLE INFO SHEET



Series: Blue Ridge MAX

Model: B4252445 Grandview Max

## Floorplan

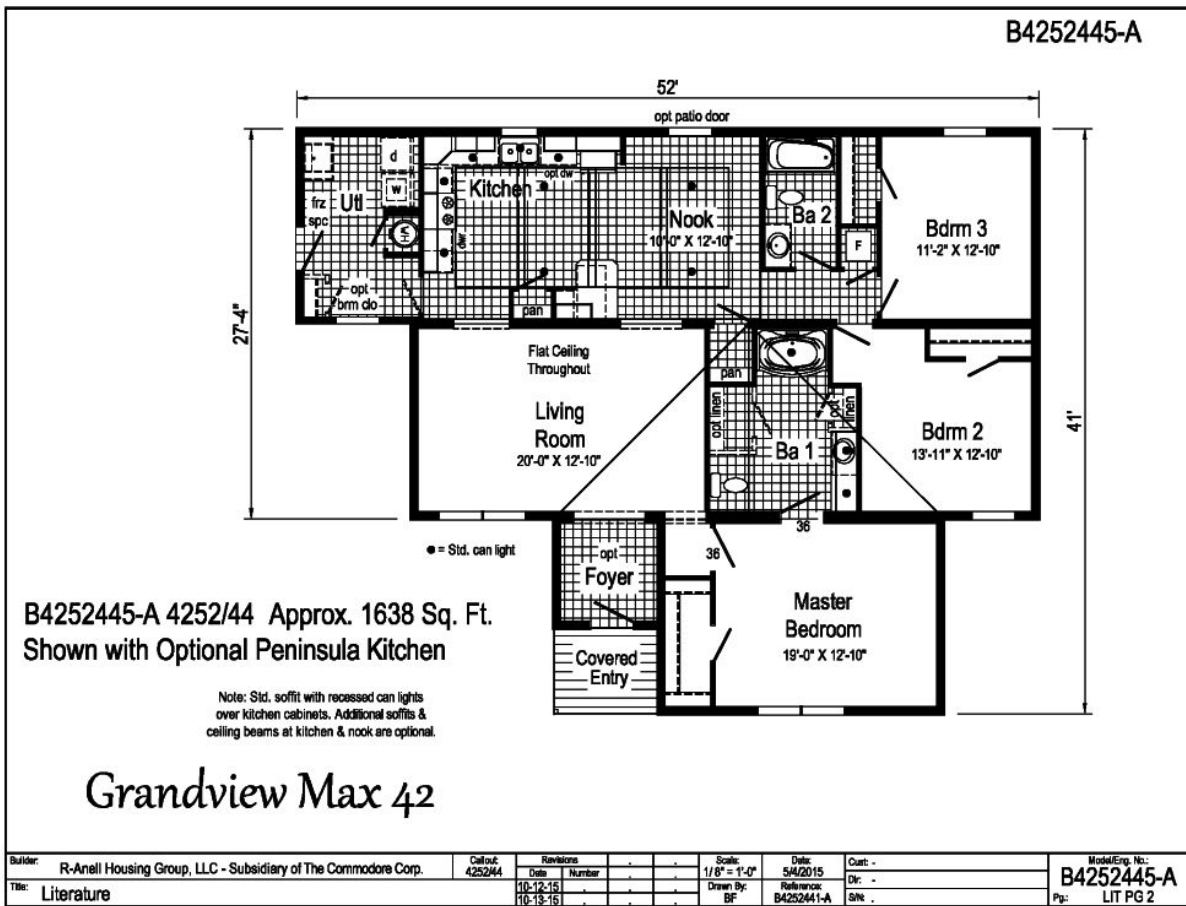

## CUSTOMER CONTACT

Notes:

---



---



---



---

# PRINTABLE INFO SHEET



**Series: Blue Ridge MAX**

**Model: B4252445 Grandview Max**

## Standards & Features

### INTERIOR

- Primed Smooth Drywall Throughout
- Flat Ceiling Throughout
- Smooth Ceiling
- 8'0" Ceiling Height
- Live Wire Carpet Protected with Shaw
- Stain Safety
- Rebond Carpet Pad
- Tackstrip Carpet Installation
- No-Wax Vinyl Floor Coverings by Congoleum
- Langford 3-Arm Dining Room Light
- Recessed 6" LED Lighting in Nook
- 6-Panel Pre-Hung Doors
- Mortise Door Hinges
- Metal Interior Passage Sets
- Door Stops
- Smoke Detectors with Battery Back-Up
- Wire Shelving in Guest Closet & Utility Room
- 2 1/4" Window & Door Trim
- White Painted Mouldings Throughout
- Laminate Countertops with Laminate Edging
- 4" Laminate Backsplash

### CABINETRY

- Evermore Custom Cabinetry (KCMA Certified)
- Hardwood Mission Cabinet Doors w/ Full Overlay
- Hardwood Cabinet Face Frames & Stiles

### CABINETRY (continued)

- Brushed Nickel Cabinet Hardware
- Concealed Cabinet Hinges
- Dovetail Drawers w/ Undermount Drawer Guides
- 30" Wall Cabinets
- Adjustable Shelves in Wall Cabinets
- Adjustable Center Shelf in Base Cabinets
- Standard Islands in Most Models
- Base Shelf in Vanities
- 36" High Vanities

### BEDROOMS

- Switched Receptacles
- Egress Window Each Bedroom
- Wire Shelves in all Walk-In Closets
- Wire Shelving in Secondary Closets
- 30" Interior Passage Doors
- Switched Recessed 4" LED Light in All Walk-In Closets
- Privacy Sets in all Bedrooms
- KITCHEN**
- Stainless Steel 33x19x7 Sink
- Empire Brushed Nickel Single Lever Faucet
- USB Receptacle
- Deluxe Free Standing Electric Range

### BATHS

- 60" x 42" Fiberglass Garden Tub in Master Bath
- 60" One-Piece Fiberglass Tub/Shower in 2nd Bath
- One-Piece Fiberglass Shower with Glass Door in Glamour Baths
- Tub Overflows

## CUSTOMER CONTACT

Notes:

---

---

---

---

# PRINTABLE INFO SHEET



**Series: Blue Ridge MAX**

**Model: B4252445 Grandview Max**

## Standards & Features (continued)

### BATHS (continued)

- 1.6 Gallon Per Flush Elongated Toilets
- China Stool, Tank and Lid
- China Sinks with Overflows and Pop-Up Drains
- Lighted Vent Fan in Each Bath
- Soffit w/ Recessed LED Lights over Vanity in Master Bath
- Langford 2-Arm Vanity Light
- Empire Brushed Nickel Faucets
- Anti-Scald Valves on Showers
- Privacy Sets in all Bathrooms
- In-Wall Toilet Riser

### UTILITIES

- 200 AMP Electrical Service
- Arc Fault Circuit Breakers
- Plumb and Wire for Washer
- Wire and Vent for Dryer
- 40 Gallon Electric Water Heater with Pan
- 6-Panel Furnace Door
- Air Ready Electric Furnace
- Fiberglass Heat Ducts
- Copper Wiring Throughout
- Main Water Line Shut-Off Valve
- Water Shut-Off Valves Where Accessible
- One Exterior Water Faucet
- Uponor Plumbing System
- Recessed Dryer Vent Box - Where Available
- Drain & Gas Lines Stubbed Through Floor
- Complete Heat System

### INSULATION

- R-19 Fiberglass Insulation in Floor
- R-13 Fiberglass Insulation in Walls &ndash; 25/38 Wide Homes
- R- 19 Fiberglass Insulation in Walls &ndash; 28/32/42 Wide Homes
- R-31 Avg. Blown Insulation in Ceiling

### EXTERIOR

- Patina Lantern Light at Front Door
- Square Lantern Light at Rear Door
- Two GFI-Protected Exterior Receptacles
- Vinyl Dutch Lap Siding
- O.S.B. Sheathing Under Siding
- 5/12 Roof Pitch
- 10" or 12" Overhangs & Eaves (Depending on Model)
- 3-Tab Shingles
- Ridgevent Roof Ventilation System
- 38x82 Fiberglass 6-Panel Front & Rear Doors with Deadbolt Locks
- Vinyl Insulated Windows with Low-E Glass
- 15" Raised Panel Shutters on Front Door Side
- Wind Wrap
- Vapor Barrier

### CONSTRUCTION

- 2x10 Transverse Floor System with 3/4" T&G O.S.B. Floor Decking
- 2x4 Exterior Walls &ndash; 25/38 Wide Homes
- 2x6 Exterior Walls &ndash; 28/32/42 Wide Homes
- 2x4 Marriage Walls

## CUSTOMER CONTACT

Notes:

---

---

---

---

## **PRINTABLE INFO SHEET**



**Series: Blue Ridge MAX**

**Model: B4252445 Grandview Max**

## **Standards & Features (continued)**

### **CONSTRUCTION (continued)**

90 Mile Exposure C Wind Load Design

20# Roof Load Design

82 1/2" Window Headers

### **Virginia Built Homes**

R-30 Fiberglass Insulation in Floor

R-19 Fiberglass Insulation in Wall

R-38 Avg. Blown Insulation in Ceiling

Foam Gaskets at Switches & Receptacles on Exterior Walls

Insulated Hot Water Lines

Deleted Factory Installed Heat Ducts and Boots

## **CUSTOMER CONTACT**

Notes:

---

---

---

---