

PRINTABLE INFO SHEET

Series: Blue Ridge MAX
Model: B28482 Cascade Max



About This Model

Style: Ranch / Bedrooms: 3 / Bathrooms: 2 / Square Feet: 1312

CUSTOMER CONTACT

Notes:

PRINTABLE INFO SHEET

Series: Blue Ridge MAX
 Model: B28482 Cascade Max



Floorplan

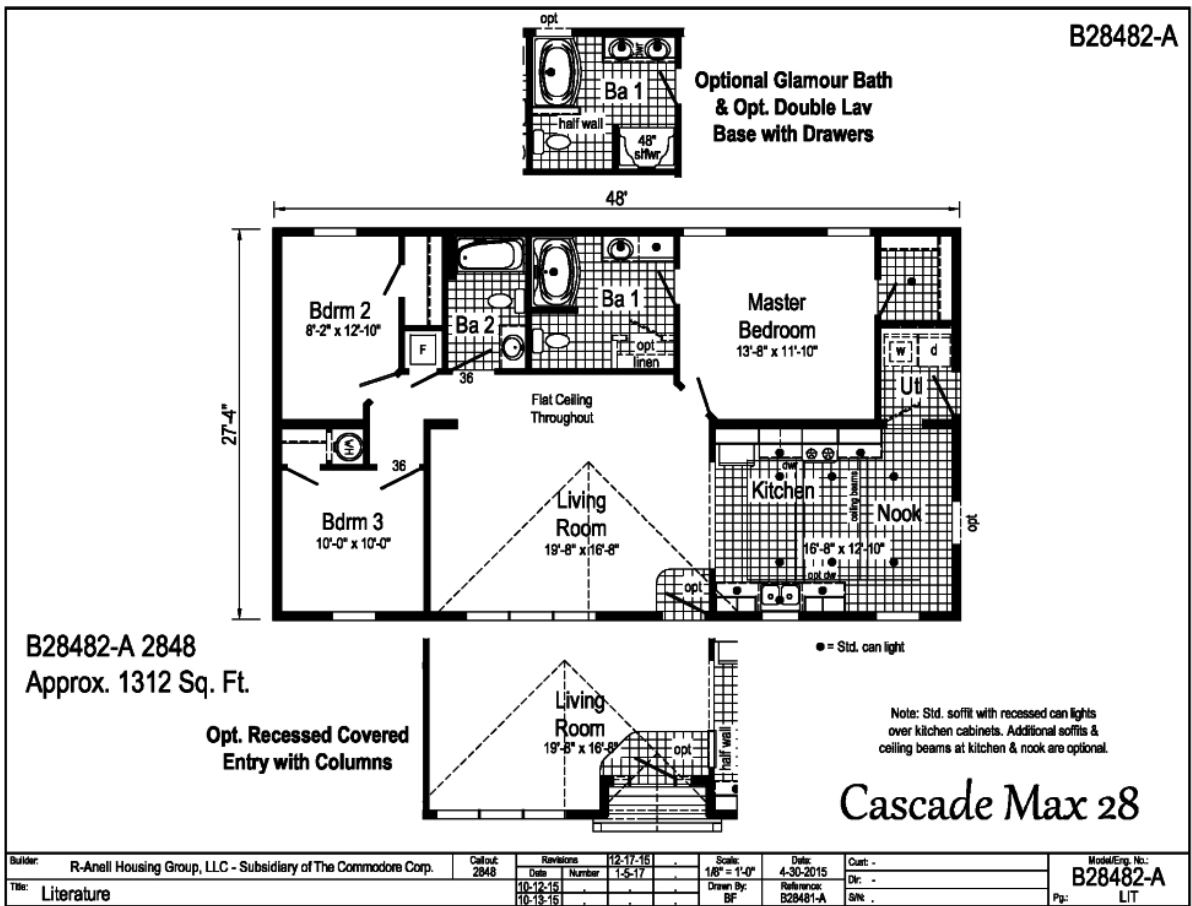

CUSTOMER CONTACT

Notes:

PRINTABLE INFO SHEET



Series: Blue Ridge MAX
 Model: B28482 Cascade Max

Floorplan

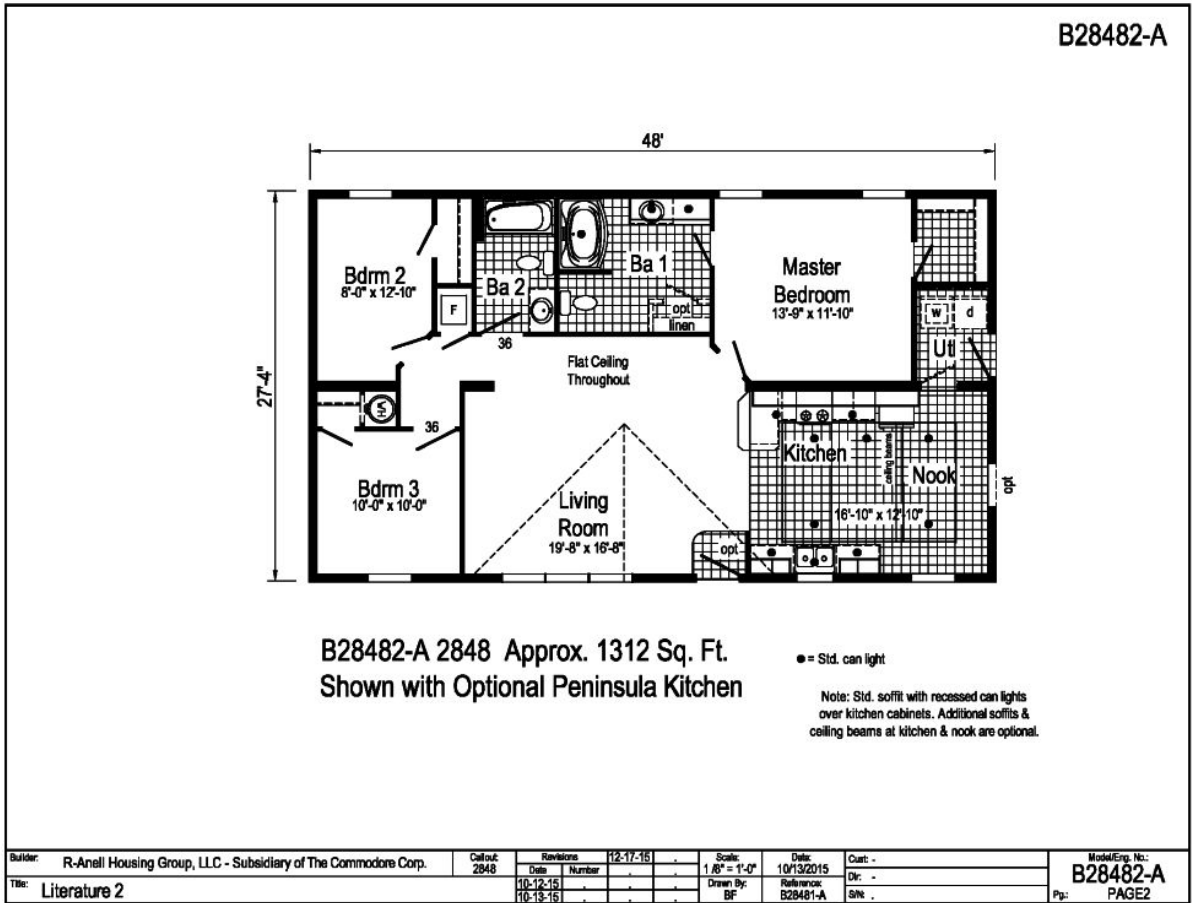

CUSTOMER CONTACT

Notes: _____

PRINTABLE INFO SHEET



Series: Blue Ridge MAX
Model: B28482 Cascade Max

Standards & Features

INTERIOR

- Primed Smooth Drywall Throughout
- Flat Ceiling Throughout
- Smooth Ceiling
- 8'0" Ceiling Height
- Live Wire Carpet Protected with Shaw
- Stain Safety
- Rebond Carpet Pad
- Tackstrip Carpet Installation
- No-Wax Vinyl Floor Coverings by Congoleum
- Langford 3-Arm Dining Room Light
- Recessed 6" LED Lighting in Nook
- 6-Panel Pre-Hung Doors
- Mortise Door Hinges
- Metal Interior Passage Sets
- Door Stops
- Smoke Detectors with Battery Back-Up
- Wire Shelving in Guest Closet & Utility Room
- 2 1/4" Window & Door Trim
- White Painted Mouldings Throughout
- Laminate Countertops with Laminate Edging
- 4" Laminate Backsplash

CABINETRY

- Evermore Custom Cabinetry (KCMA Certified)
- Hardwood Mission Cabinet Doors w/ Full Overlay
- Hardwood Cabinet Face Frames & Stiles

CABINETRY (continued)

- Brushed Nickel Cabinet Hardware
- Concealed Cabinet Hinges
- Dovetail Drawers w/ Undermount Drawer Guides
- 30" Wall Cabinets
- Adjustable Shelves in Wall Cabinets
- Adjustable Center Shelf in Base Cabinets
- Standard Islands in Most Models
- Base Shelf in Vanities
- 36" High Vanities

BEDROOMS

- Switched Receptacles
- Egress Window Each Bedroom
- Wire Shelves in all Walk-In Closets
- Wire Shelving in Secondary Closets
- 30" Interior Passage Doors
- Switched Recessed 4" LED Light in All Walk-In Closets
- Privacy Sets in all Bedrooms
- KITCHEN**
- Stainless Steel 33x19x7 Sink
- Empire Brushed Nickel Single Lever Faucet
- USB Receptacle
- Deluxe Free Standing Electric Range

BATHS

- 60" x 42" Fiberglass Garden Tub in Master Bath
- 60" One-Piece Fiberglass Tub/Shower in 2nd Bath
- One-Piece Fiberglass Shower with Glass Door in Glamour Baths
- Tub Overflows

CUSTOMER CONTACT

Notes: _____

PRINTABLE INFO SHEET



Series: Blue Ridge MAX

Model: B28482 Cascade Max

Standards & Features (continued)

BATHS (continued)

1.6 Gallon Per Flush Elongated Toilets
China Stool, Tank and Lid
China Sinks with Overflows and
Pop-Up Drains
Lighted Vent Fan in Each Bath
Soffit w/ Recessed LED Lights over
Vanity in Master Bath
Langford 2-Arm Vanity Light
Empire Brushed Nickel Faucets
Anti-Scald Valves on Showers
Privacy Sets in all Bathrooms
In-Wall Toilet Riser

UTILITIES

200 AMP Electrical Service
Arc Fault Circuit Breakers
Plumb and Wire for Washer
Wire and Vent for Dryer
40 Gallon Electric Water Heater with Pan
6-Panel Furnace Door
Air Ready Electric Furnace
Fiberglass Heat Ducts
Copper Wiring Throughout
Main Water Line Shut-Off Valve
Water Shut-Off Valves Where Accessible
One Exterior Water Faucet
Uponor Plumbing System
Recessed Dryer Vent Box - Where Available
Drain & Gas Lines Stubbed Through Floor
Complete Heat System

INSULATION

R-19 Fiberglass Insulation in Floor
R-13 Fiberglass Insulation in Walls –
25/38 Wide Homes
R- 19 Fiberglass Insulation in Walls –
28/32/42 Wide Homes
R-31 Avg. Blown Insulation in Ceiling

EXTERIOR

Patina Lantern Light at Front Door
Square Lantern Light at Rear Door
Two GFI-Protected Exterior Receptacles
Vinyl Dutch Lap Siding
O.S.B. Sheathing Under Siding
5/12 Roof Pitch
10" or 12" Overhangs & Eaves
(Depending on Model)
3-Tab Shingles
Ridgevent Roof Ventilation System
38x82 Fiberglass 6-Panel Front & Rear
Doors with Deadbolt Locks
Vinyl Insulated Windows with Low-E Glass
15" Raised Panel Shutters on Front
Door Side
Wind Wrap
Vapor Barrier

CONSTRUCTION

2x10 Transverse Floor System with
3/4" T&G O.S.B. Floor Decking
2x4 Exterior Walls – 25/38 Wide Homes
2x6 Exterior Walls – 28/32/42 Wide Homes
2x4 Marriage Walls

CUSTOMER CONTACT

Notes:

PRINTABLE INFO SHEET

Series: Blue Ridge MAX
Model: B28482 Cascade Max



Standards & Features (continued)

CONSTRUCTION (continued)

90 Mile Exposure C Wind Load Design

20# Roof Load Design

82 1/2" Window Headers

Virginia Built Homes

R-30 Fiberglass Insulation in Floor

R-19 Fiberglass Insulation in Wall

R-38 Avg. Blown Insulation in Ceiling

Foam Gaskets at Switches & Receptacles
on Exterior Walls

Insulated Hot Water Lines

Deleted Factory Installed Heat Ducts
and Boots

CUSTOMER CONTACT

Notes:
